

Fire Sprinkler piping systems shall employ Aegis Branchlet Welding Outlets to provide threaded or grooved outlets on main and/or branch pipes.

Aegis Branchlet Welding Outlets shall be:

- Designed for wet or dry automatic sprinkler systems in accordance to NFPA 13, 13R, & 13D
- Rated for 300 psi.
- Listed in accordance to UL 213B with qualifying tests up to 1500 psi.
- Approved in accordance to FM Class 1920 with qualifying tests up to 1200 psi.
- Manufactured from highly weldable carbon steel conforming to ASTM 1010, A53, A135, or A795.
- Marked with a lot number to provide full traceability and quality assurance.
- Threads to conform to B1.20.1 NPT. Grooves to conform to Victaulic IGS or OGS cut or roll grooves.
- Produced in the United States of America by Aegis Technologies, Inc. of Pottstown, Pennsylvania.
www.aegistechnologiesinc.com

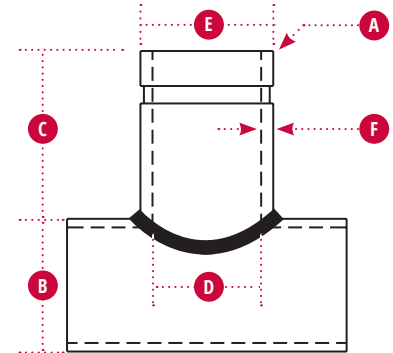

TYPE 3G & 3RG OGS GROOVED OUTLET

OUTLET A NOMINAL IN	HEADER B IN	OUTLET LENGTH C IN	INSIDE DIAMETER		OUTSIDE DIAMETER E IN	WALL THICKNESS		WEIGHT SCH 40 LBS	BOX QUANTITY
			SCH 40 D IN	SCH 10 IN		SCH 40 F IN	SCH 10 IN		
1	x	1.25 - 8	3		1.050			0.40	50
1.25	x	1.25 - 8	3		1.380			0.56	80
1.5	x	1.5 - 8	3		1.610			0.61	50
2	x	2 - 8	3		2.067			0.90	30
2.5	x	2.5 - 8	3		2.469			1.49	20
3	x	3 - 8	3		3.068			1.98	15
4	x	4 - 12*	4		4.026			3.62	10
6	x	6 - 12*	4	6.357	6.625	0.280	0.134	6.93	3.8
8	x	8 - 12*	4	8.329	8.625	0.322	0.148	10.75	6.2
10	x	10 - 12*	5	10.020	10.750	0.365		20.73	1

*Some sizes are not UL Listed or FM Approved. Refer to the UL Directory and/or FM Guide.

TYPE 3F NPT THREADED OUTLET

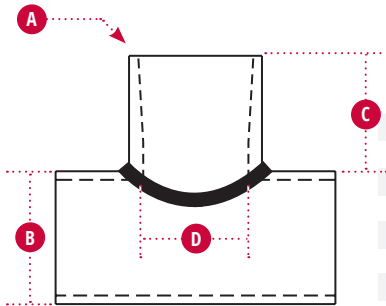

OUTLET A IN	HEADER B IN	OUTLET LENGTH C IN	INSIDE DIA. D IN	WEIGHT LBS	BOX QUANTITY
0.5 x	1.25 - 8	1.0625	0.7	0.13	325
0.75 x	1.25 - 8	1.125	0.9	0.21	200
1 x	1.25 - 8	1.25	1.145	0.31	125
1.25 x	1.25 - 8	1.375	1.47	0.41	70
1.5 x	1.5 - 8	1.625	1.61	0.51	50
2 x	2 - 8	1.75	2.067	0.83	25
2.5 x	2.5 - 8	2.125	2.469	1.25	35

TYPE 3V VICTAULIC® IGS™ GROOVED OUTLET

OUTLET A IN	HEADER B IN	OUTLET LENGTH C IN	INSIDE DIA. D IN	WEIGHT LBS	BOX QUANTITY
1 x	1.25 - 4	1	1.05	0.15	200

Victaulic® and IGS® are trademarks of Victaulic Company, and are used with permission.

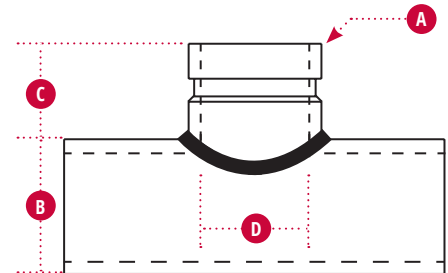

PROJECT INFORMATION

Project: _____

Date: _____ Phone: _____

Architect / Engineer: _____ Contractor: _____

Address: _____

Notes 1: _____

Notes 2: _____

APPROVAL STAMP